

The remainder of George Croghan's Survey of which this is a part

No. of Courses	Courses down Plumb Creek	Distances
1	N 30° W	20
2	West	16
3	S 50° W	30
4	West	19
5	N 26° W	36
6	West	37
7	S 20° W	24 3/4
8	S 38° W	62
9	N 40° W	13
Total Distances		257 1/4

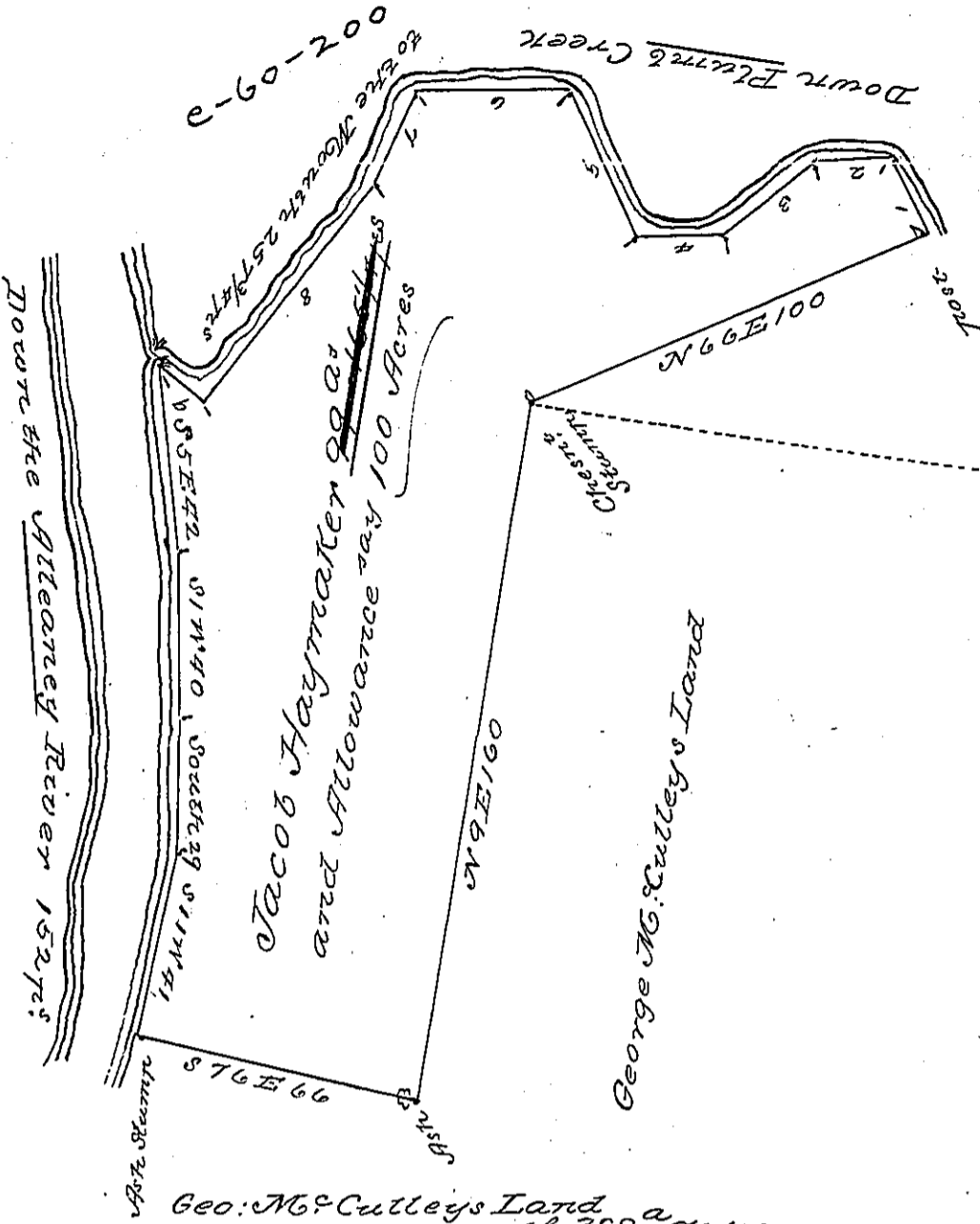

A Draught of part of a Survey ^{of 388 1/2 acres} formerly made to George Croghan Dec^d at the Mouth of Plumb Creek on the South side of Allegheny River in Pitt Township Westmoreland County containing Ninety nine Acres & One Hundred & Sixty five perches with an allowance proportioned to Six per Cent Surveyd Dec^r 12th 1787

John Moore D.S.

To John Lukens Esq. S. S.

N^o 21 dated 1st April 1769-

N^o 21 the Survey of which the above is a part was Surveyed to Geo: Croghan In pursuance of a Special Order N^o 21 and said to be sold by him to Jacob Haymaker.

John Moore D.S.

IN TESTIMONY that the above is a copy of the original remaining on file in the Department of Internal Affairs of Pennsylvania, made conformably to an Act of Assembly approved the 16th day of February, 1833, I have hereunto set my Hand and caused the Seal of said Department to be affixed at Harrisburg, this

Records _____ day of November _____ 1897

James W. Fatta
Secretary of Internal Affairs.